

Suggested PCB Layout
Tolerance: ±0.05

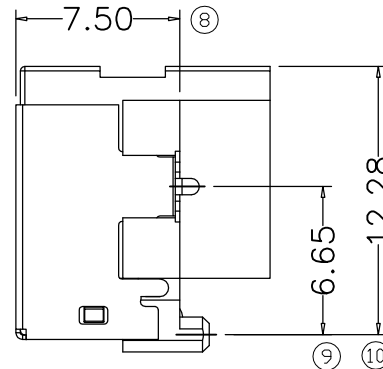
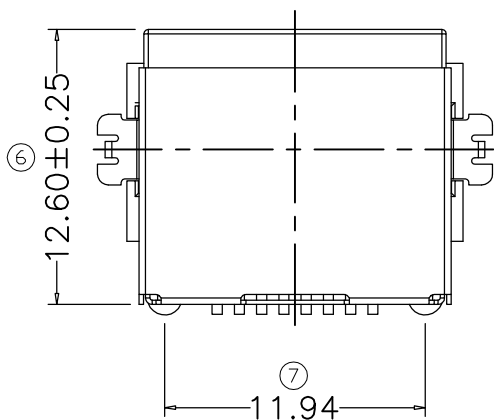

ELECTRICAL:

- VOLTAGE RATING: 125 VAC RMS
- CURRENT RATING: 1.5 AMP
- CONTACT RESISTANCE: 20MΩ MAX.
- INSULATION RESISTANCE: 500MΩMIN. AT 500V DC.
- DIELECTRIC STRENGTH: 1000 VAC 50HZ 1MINUTE.

MECHANICAL:

- HOUSING MATERIAL: LCP UL94V-0 RATED, COLOR BLACK.
- CONTACT MATERIAL: PHOSPHOR BRONZE.
- CONTACT PLATING: PLATED NICKEL 50U"MIN. UNDER PLATING ALL, PLATED TIN ON SOLDER TAILS 100U" MIN. GOLD PLATED ON CONTACT AREA FU".
- SHIELD: COPPER ALLOY PLATED WITH NICKEL 30U"MIN.
- OPERATING LIFE: 750 CYCLES MIN.
- MATING FORCE: 22.24N MAX. UNMATING FORCE: 44.48N MAX.
- REFLOW SOLDERING TEMP.: 260°±5° 5-10 SECONDS.
- JACK CAVITY CONFORMS TO FCC RULES AND REGULATIONS PART 68, SUBPART F.

ENVIRONMENTAL:

- STORAGE: -40°C TO +85°C
- OPERATION: -40°C TO +85°C

SCHEMATIC

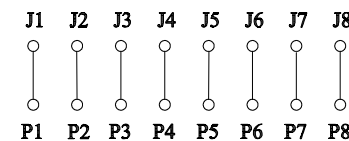

DETACHED LISTS	 公差: TOLERANCES		绘图: (Designed)	<h1 style="text-align: center;">Coorle Technology</h1>		
	MM	MM	审核: (Checked)			
	.0 ± 0.38	±	批准: (Approved)	系列 (SERIES)	名称 (NAME)	
	.00 ± 0.25	±	日期: (Date)	RJ	RJ45 8P8C 全包沉板SMT式H7.5	
	.000 ± 0.15	±	比例: (SCALE)	2024.03.12	类别CATEGORY:	成品图
 第三角视图				料号 PART NO:	版本 REV.	A.0
				1:1	单位 (UNIT): MM	共 (SHEET) 1 页 第 (OF) 1 页